

New!

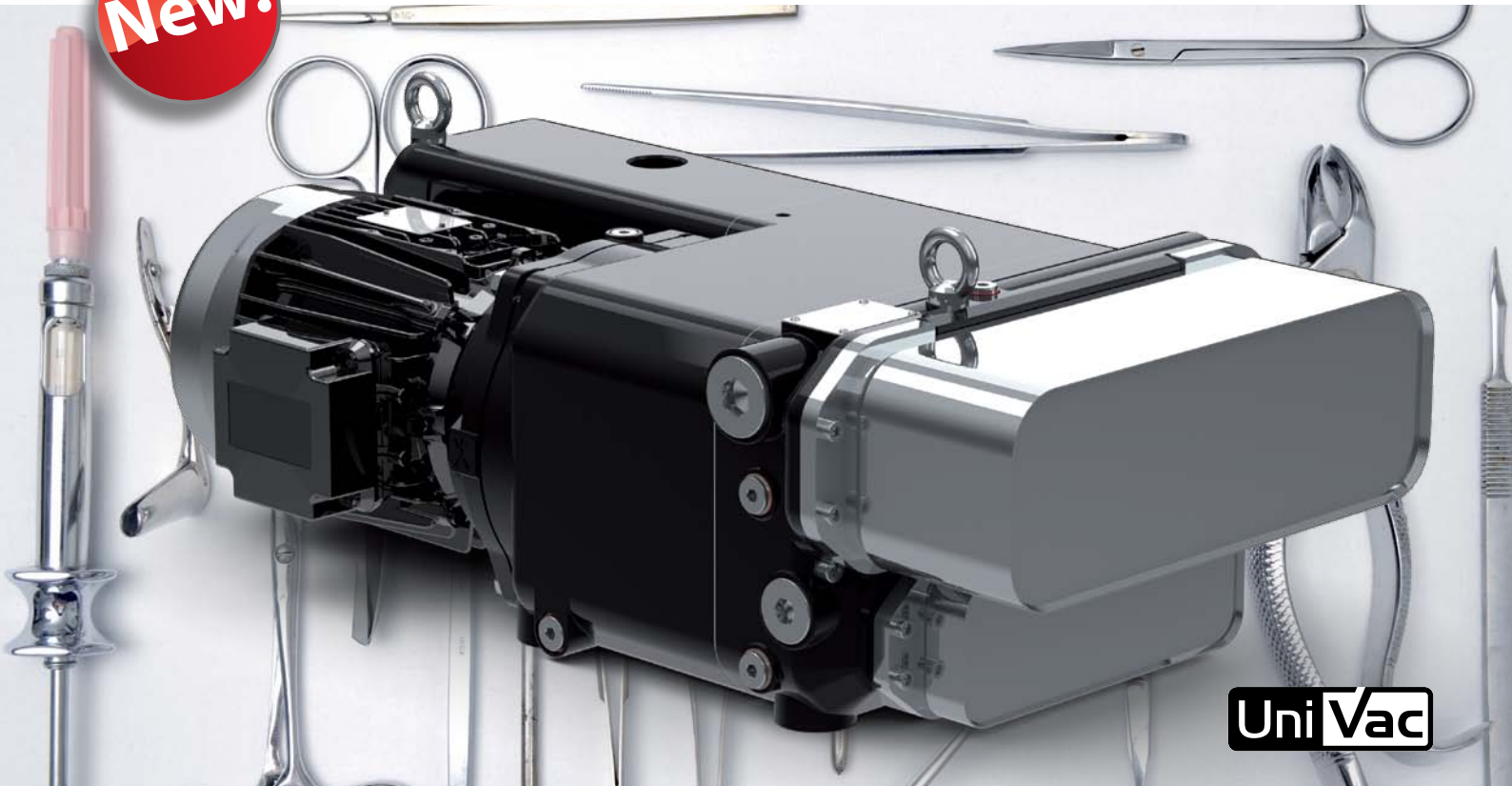

Plug-and-Play Vacuum Units for Sterilisers

*Vacuum units with
liquid ring vacuum pump, separator, condenser and heat exchanger
for quick and easy installation*

Preinstalled components in minimum space

Liquid ring vacuum pump

Particularly low-noise two-stage pumps of the VZ series - designed as cartridge insert for easy disassembly

Air discharge opening

Direct discharge of exhaust air to the environment

Condenser

For media withdrawn by suction from the steriliser
Easy disassembly when required

Separator

For separating the gas-liquid mixture from the process

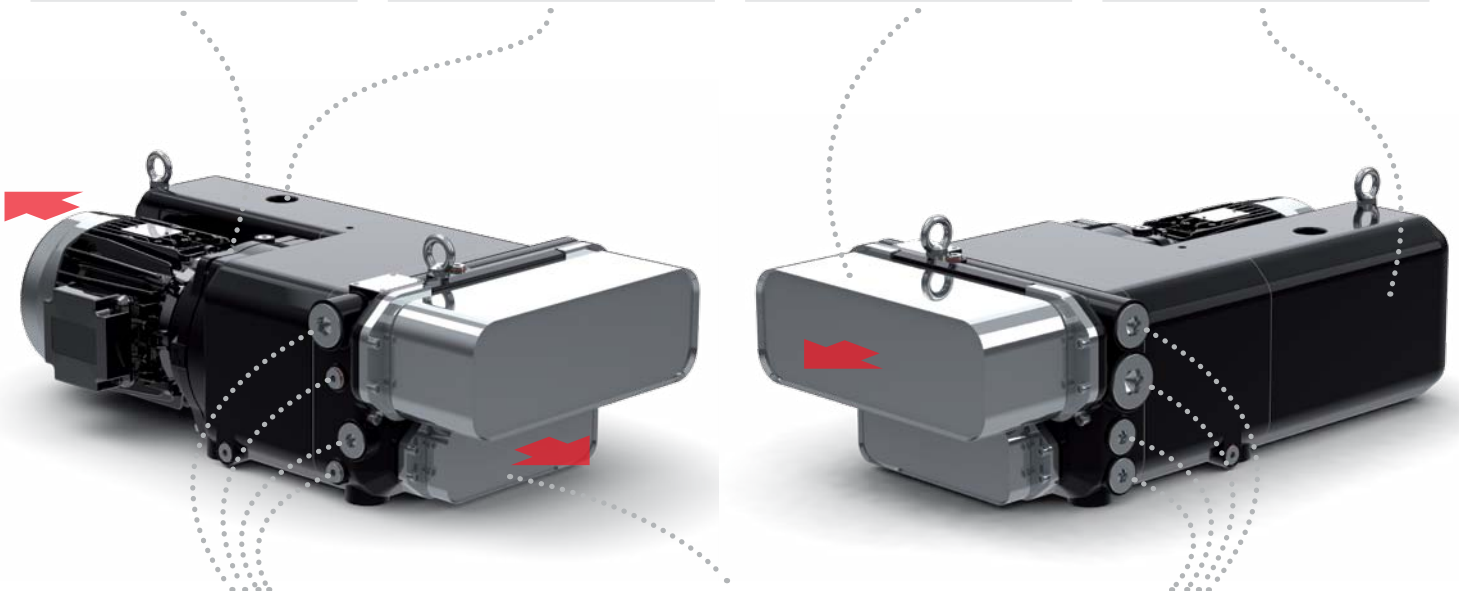

Process fittings

Inlet of condenser cooling water
Ventilation valve or sensor connection
Inlet of heat exchanger cooling water
Inlet of vacuum pump operating water

Heat exchanger (optional)

For cooling of operating water
Easy retrofitting or disassembly when required

Process fittings

Outlet of condenser cooling water
Suction connection
Outlet of heat exchanger cooling water
Outlet of vacuum pump operating water

UniVac

Fast installation

All components of the UniVac compact unit including vacuum pump, separator, condenser and optional heat exchanger are already connected to each other → simply install the UniVac unit, connect the process fittings and start right away.

Easy maintenance

The vacuum pump is designed as cartridge insert for effortless disassembly during maintenance or replacement. Also the heat exchanger and condenser can be replaced without the need to disassemble the piping.

Intelligent and extremely compact design

The tried-and-tested two-stage liquid ring vacuum pumps of the VZ series feature particularly low-noise operation and integrated cavitation protection.

Exhaust process air can be directly discharged to the environment. Due to its extremely compact design, the UniVac compact unit requires only minimum space inside the steriliser. If required, the optionally available heat exchanger can be retrofitted.

	UniVac-30-2	UniVac-50-2	UniVac-100-2
Width/height/depth	340 x 200 x 600	340 x 200 x 640	340 x 220 x 740
Weight	54 kg	65 kg	84 kg
Material design	cast iron	cast iron	cast iron
Power requirements	1.0 kW (50 Hz) 1.5 kW (60 Hz)	1.5 kW (50 Hz) 2.2 kW (60 Hz)	3.0 kW (50 Hz) 4.0 kW (60 Hz)
Q _{max}	28 m ³ /h	49 m ³ /h	94 m ³ /h
p _{min}	33 mbar	33 mbar	33 mbar

speck



Speck Pumpen Vakuumtechnik GmbH
Regensburger Ring 6 – 8, 91154 Roth

Phone: + 49 9171 809 0
Fax: + 49 9171 809 10

info@speck.de
www.speck.de